

TOWN AND COUNTRY PLANNING ACT 1971, as amended by the  
LOCAL GOVERNMENT, PLANNING AND LAND ACT 1980

BOROUGH COUNCIL OF KING'S LYNN AND WEST NORFOLK  
(GRIMSTON AND CONGHAM) TREE PRESERVATION ORDER 1983 No. 1

The Borough Council of King's Lynn & West Norfolk in this Order called "the Authority" in pursuance of the powers conferred in that behalf by Sections 60 and 61 of the Town and Country Planning Act 1971 as amended by the Local Government Planning and Land Act 1980 and subject to the provisions of the Forestry Act, 1967, hereby makes the following order:-

1. In this Order -

"the Act" means the Town and Country Planning Act, 1971 as amended by the Local Government, Planning and Land Act 1980, "owner" means the owner in fee simple, either in possession or who has granted a lease or tenancy of which the unexpired portion is less than three years; lessee (including a sub-lessee) or tenant in possession, the unexpired portion of whose lease or tenancy is three years or more; and a mortgagee in possession, and "the Secretary of State" means the Secretary of State for the Environment.

2. Subject to the provisions of this Order and to the exemptions specified in the Second Schedule hereto, no person shall, except with the consent of the authority and in accordance with the conditions, if any imposed on such consent, cut down, top, lop uproot wilfully damage or wilfully destroy or cause or permit the cutting down, topping, looping, uprooting, wilful damage or wilful destruction of any tree specified in the First Schedule hereto or comprised in a group of trees or in a woodland therein specified, the position of which trees, groups of trees and woodlands is defined in the manner indicated in the said First Schedule on the map annexed hereto which map shall, for the purpose of such definition as aforesaid, prevail where any ambiguity arises between it and the specification in the said First Schedule.
3. An application for consent made to the authority under Article 2 of this Order shall be in writing stating the reasons for making the application, and shall by reference if necessary to a plan specify the trees to which the application relates, and the operations for the carrying out of which consent is required.
4. (1) Where an application for consent is made to the authority under this Order, the authority may grant such consent either unconditionally, or subject to such conditions (including conditions requiring the replacement of any tree by one or more trees on the site or in the immediate vicinity thereof), as the authority may think fit, or may refuse consent:

Provided that where the application relates to any woodland specified in the First Schedule to this Order the authority shall grant consent so far as accords with the principles of good forestry, except where, in the opinion of the authority, it is necessary in the interests of amenity to maintain the special character of the woodland or the woodland character of the area, and shall not impose conditions on such consent requiring replacement or replanting.

(2) The authority shall keep a register of all applications for consent under this Order containing information as to the nature of the application, the decision of the authority thereon, any compensation awarded in consequence of such decision and any directions as to replanting of woodlands; and every such register shall be available for inspection by the public at all reasonable hours.

5. Where the authority refuse consent under this Order or grant such consent subject to conditions they may when refusing or granting consent certify in respect of any trees for which they are so refusing or granting consent that they are satisfied -

(a) that the refusal or condition is in the interest of good forestry; or

(b) in the case of trees other than trees comprised in woodlands, that the trees have an outstanding or special amenity value.

6. (1) Where consent is granted under this Order to fell any part of a woodland other than consent for silvicultural thinning then unless -

(a) such consent is granted for the purpose of enabling development to be carried out in accordance with a permission to develop land under Part III of the Act, or

(b) the authority with the approval of the Secretary of State dispense with replanting,

the authority shall give to the owner of the land on which that part of the woodland is situated a direction in writing specifying the manner in which and the time within which he shall replant such land and where such a direction is given and the part is felled the owner shall, subject to the provision of this Order and section 175 of the Town and Country Planning Act 1971 replant the said land in accordance with the direction.

(2) Any direction given under paragraph (1) of this Article may include requirements as to -

(a) species;

(b) number of trees per acre;

(c) the erection and maintenance of fencing necessary for protection of the replanting;

(d) the preparation of ground, draining, removal of brushwood, lop and top; and

(e) protective measures against fire

7. On imposing any condition requiring the replacement of any tree under Article 4 of the Order, or on giving a direction under Article 6 of this Order with respect to the replanting of woodlands, the authority shall if such condition or direction relates to land in respect of which byelaws made by a river authority, a drainage board, the Conservators of the River Thames or the Lee Conservancy Catchment Board restrict or regulate the planting of trees, notify the applicant or the owner of the land, as the case may be, of the existence of such byelaws and that any such condition or direction

has effect subject to the requirements of the river authority, drainage board, the Conservators of the River Thames or the Lee Conservancy Catchment Board under those byelaws and the condition or direction shall have effect accordingly.

8. The provisions set out in the Third Schedule to this Order, being provisions of Part III of the Act shall apply in relation thereto.
9. Subject to the provisions of this Order, any person who has suffered loss or damage in consequence of any refusal (including revocation or modification) of consent under this Order or of any grant of any such consent subject to conditions, shall, if he makes a claim on the authority within the time and in the manner prescribed by this Order, be entitled to recover from the authority compensation in respect of such loss or damage:

Provided that no compensation shall be payable in respect of loss or damage suffered by reason of such refusal or grant of consent in the case of any trees the subject of a certificate in accordance with Article 5 of this Order.

10. In assessing compensation payable under the last preceding Article account shall be taken of:

(a) any compensation or contribution which has been paid whether to the claimant or any other person, in respect of the same trees under the terms of this or any other Tree Preservation Order under section 60 of the Act or under the terms of any Interim Preservation Order made under Section 8 of the Town and Country Planning (Interim Development) Act 1943, or any compensation which has been paid or which could have been claimed under any provisions relating to the preservation of trees or protection of woodlands contained in an operative scheme under the Town and Country Planning Act 1932, and

(b) any injurious affection to any land of the owner which would result from the felling of the trees the subject of the claim.

11. (1) A claim for compensation under this Order shall be in writing and shall be made by serving it on the authority, such service to be effected by delivering the claim at the offices of the authority addressed to the Borough Secretary thereof or by sending it by prepaid post so addressed.

(2) The time within which any such claim shall be made as aforesaid shall be a period of twelve months from the date of the decision of the authority, or of the Secretary of State, as the case may be, or where an appeal has been made to the Secretary of State against the decision of the authority, from the date of the decision of the Secretary of State on the appeal

12. Any question of disputed compensation shall be determined in accordance with the provisions of section 179 of the Act.

13. The provisions of Section 61 of the Act shall apply to this Order and the Order shall take effect from the date specified below.

NOTE: Any person contravening the provisions of this Order by cutting down, uprooting or wilfully destroying a tree, or by wilfully damaging, topping or lopping a tree in such a manner as to be likely to destroy it is guilty of an offence and liable on summary conviction to a fine not exceeding £1,000 or twice the sum which appears to the court to be the value of the tree, whichever is the greater, or on indictment to a fine. The penalty for any other contravention of this Order is a fine not exceeding £200 on summary conviction and, in the case of a continuing offence when the contravention is continued after conviction, a person is liable on summary conviction to an additional fine not exceeding £5 for every day on which the contravention is so continued.

If a tree other than one to which an Order applies as part of a woodland is removed, uprooted or destroyed in contravention of an Order or is removed, uprooted or destroyed or dies at a time when its cutting down or uprooting is authorised only by section 60(6) of the Act, relating to trees which are dying or dead or have become dangerous, it is the duty of the owner of the land, unless on his application the local planning authority dispense with the requirement, to plant another tree of appropriate size and species at the same place as soon as he reasonably can. Except in emergency, not less than 5 days previous notice of the removal, etc., should be given to the authority to enable the latter to decide whether or not to dispense with the requirement.

FIRST SCHEDULE

TREES SPECIFIED INDIVIDUALLY

<u>No. on Map</u>	<u>Description</u>	<u>Situation</u>
T1	Chestnut	
T2	Chestnut	
T3	Chestnut	Within O.S. 8100
T4	Chestnut	Congham
T5	Chestnut	
T6	Chestnut	
T7	Chestnut	
T8	Chestnut	
T9	Chestnut	
T10	Chestnut	
T11	Chestnut	
T12	Chestnut	
T13	Chestnut	Within O.S. 9279
T14	Chestnut	Congham
T15	Chestnut	
T16	Chestnut	Within O.S. 0023 Congham
T17	Chestnut	
T18	Chestnut	
T19	Chestnut	
T20	Chestnut	
T21	Chestnut	Within O.S. 0004
T22	Chestnut	Congham
T23	Chestnut	
T24	Chestnut	
T25	Chestnut	
T26	Chestnut	
T27	Chestnut	
T28	Chestnut	
T29	Chestnut	With O.S. 0082
T30	Chestnut	Congham

<u>No. on Map</u>	<u>Description</u>	<u>Situation</u>
T31	Chestnut	
T32	Chestnut	Within O.S. 0082
T33	Chestnut	Congham
T34	Chestnut	
T35	Chestnut	Manor Farm,
T36	Chestnut	29 Gayton Road, Grimston.
T37	Sycamore	<i>THE LIMES, GAYTON Rd. GRIMSTON,</i>  <i>WILLOW HOUSE,</i> Watery Lane, Grimston
T38	Walnut	
T39	Chestnut	
T40	Sycamore	
T41	Sycamore	
T42	Sycamore	
T43	Sycamore	
T44	Chestnut	Within O.S. 3451
T45	Sycamore	Elder Lane,
T46	Sycamore	Grimston
T47	Chestnut	
T48	Sycamore	
T49	Sycamore	Elder Farm, Elder Lane, Grimston.
T50	Sycamore	O.S. 2651
T51	Sycamore	Elder Lane, Grimston.
T52	Sycamore	Within O.S. 2358
T53	Chestnut	Grimston
T54	Sycamore	
T55	Sycamore	Within O.S. 3451
T56	Sycamore	Gayton Road, Grimston.
T57	Lime	Within O.S. 4133 Gayton Road, Grimston.

<u>No. on Map</u>	<u>Description</u>	<u>Situation</u>
T58	Lime	Land adjoining
T59	Lime	The Old Rectory,
T60	Lime	Grimston.
T61	Lime	Land adjoining
T62	Lime	The Old Rectory, Grimston.
T63	Lime	
T64	Lime	Over-the-way,
T65	Lime	Massingham Road,
T66	Lime	Grimston.
T67	Chestnut	
T68	Chestnut	O.S. 8766
T69	Chestnut	Grimston
T70	Ash	O.S. 5177
T71	Ash	Little Lane, Grimston.
T72	Pine	Hillington House,
T73	Pine	24 Chequers Road, Grimston.
T74	Ash	O.S. 4175
T75	Oak	Chequers Road, Grimston.
T76	Oak	87 Chapel Road, Pott Row.
T77	Oak	Sunnyside,
T78	Ash	46 Chapel Road, Pott Row.
T79	Oak	O.S. 6000,
T80	Oak	Back Lane,
T81	Oak	Pott Row,
T82	Oak	Grimston.
T83	Oak	The Firs,
T84	Oak	7 Back Lane, Pott Row.

<u>No. on Map</u>	<u>Description</u>	<u>Situation</u>
T85	Lime	The Green, Pott Row.
T86	Oak	O.S. 4400
T87	Oak	Pott Row,
T88	Oak	Grimston.
T89	Sycamore	Coventry House, Cliffe-en-Howe Road, Pott Row.
T90	Oak	O.S. 4874 Ashwicken Road, Pott Row.
T91	Oak	Horsley House,
T92	Ash	12 Leziate Drove,
T93	Oak	Pott Row.
T94	Oak	
T95	Oak	The Cottage, 15 Leziate Drove, Pott Row.
T96	Ash	O.S. 8100
T97	Ash	Congham

### Groups of Trees

<u>No. on Map</u>	<u>Description</u>	<u>Situation</u>
G1	3 Willow, 2 Ash	The Springs 52 Gayton Road, Grimston.
G2	4 Pine, 1 Ash	Willow House, Watery Lane, Grimston.
G3	2 Chestnuts, 1 Spruce 4 Pines, 1 Holly, 1 Sycamore	The Shaws, 21 Chequers Road, Grimston.

Woodlands

<u>No. on Map</u>	<u>Description</u>	<u>Situation</u>
W1	Mixed Woodland	The Old Rectory, Grimston.

SECOND SCHEDULE

This Order shall not apply so as to require the consent of the authority to -

- (1) the cutting down of any trees on land which is subject to a forestry dedication covenant where
  - (a) any positive covenants on the part of the owner of the land contained in the same deed as the forestry dedication covenant and at the time of the cutting down binding on the then owner of the land are fulfilled;
  - (b) the cutting down is in accordance with a plan of operations approved by the Forestry Commission under such deed.
- (2) the cutting down of any tree which is in accordance with a plan of operations approved by the Forestry Commission under the approved woodlands scheme or other grant scheme under section 4 of the Forestry Act, 1967, except a scheme which applies to a forestry dedication covenant;
- (3) the cutting down, uprooting, topping or lopping of a tree
  - (a) in pursuance of the power conferred on the Postmaster General by virtue of section 5 of the Telegraph (Construction) Act 1908;
  - (b) by or at the request of
    - (i) a statutory undertaker where the land on which the tree is situated is operational land as defined by the Act and either works on such land cannot otherwise be carried out or the cutting down, topping or lopping is for the purpose of securing safety in the operation of the undertaking;
    - (ii) an electricity board within the meaning of the Electricity Act, 1947, where such tree obstructs the construction by the board of any main transmission line or other electric line within the meaning respectively of the Electricity (Supply) Act, 1919 and the Electric Lighting Act 1882 or interferes or would interfere with the maintenance or working of any such line;
    - (iii) a river authority established under the Water Resources Act, 1963, a drainage board constituted or treated as having been constituted under the Land Drainage Act 1930, the Conservators of the River Thames, or the Lee Conservancy Catchment Board, where the tree interferes or would interfere with the exercise of any of the functions of such river authority, drainage board, Conservators of the River Thames or Lee Conservancy Catchment Board in relation to the maintenance, improvement or construction of water courses or of drainage works; or
    - (iv) the Minister of Defence for the Royal Air Force, the Minister of Technology or the Board of Trade where in the opinion of such Minister or Board the tree obstructs the approach of aircraft to, or their departure from any aerodrome or hinders the safe and efficient use of aviation or defence technical installations;

(c) where immediately required for the purpose of carrying out development authorised by the planning permission granted on an application made under Part III of the Act, or deemed to have been so granted for any of the purposes of that Part;

(d) which is a fruit tree cultivated for fruit production growing or standing on land comprised in an orchard or garden;

### THIRD SCHEDULE

Provisions of the following parts of Part III of the Act as adapted and modified apply to this Order.

- Reference applications to Secretary of State.
33. (1) Without prejudice to the following provisions as to the revocation or modification of consents, any consent under the Order, including any direction as to replanting given by the authority on the granting of such consent, shall (except in so far as the consent otherwise provides), enure for the benefit of the land and of all persons for the time being interested therein.
35. (1) The Secretary of State may give directions to the authority requiring applications for consent under the Order to be referred to him instead of being dealt with by the authority.
35. (2) A direction under this section may relate either to a particular application or to applications of a class specified in the direction.
35. (3) Any application in respect of which a direction under this section has effect shall be referred to the Secretary of State accordingly.
35. (4) Where an application for consent under the Order is referred to the Secretary of State under this section, the provisions of Articles 4 and 5 of the Order shall apply as they apply to an application which falls to be determined by the authority.
35. (5) Before determining an application referred to him under this section the Secretary of State shall, if either the applicant or the authority so desire, afford to each of them an opportunity of appearing before, and being heard by, a person appointed by the Secretary of State for this purpose.
35. (6) The decision of the Secretary of State of any application referred to him under this section shall be final.
- Appeals against decisions
36. (1) Where an application is made to the authority for consent under the Order and that consent is refused by that authority or is granted by them subject to conditions or where any certificate or direction is given by the authority the applicant, if he is aggrieved by their decision on the application, or by any such certificate, or the person directed if he is aggrieved by the direction, may by notice under this section appeal to the Secretary of State.

36. (2) A notice under this section shall be served in writing within twenty-eight days from the receipt of notification of the decision, certificate or direction, as the case may be, or such longer period as the Secretary of State may allow.
36. (4) Where an appeal is brought under this section from a decision, certificate or direction of the authority, the Secretary of State, subject to the following provisions of this section, may allow or dismiss the appeal or may reverse or vary any part of the decision of the authority, whether the appeal relates to that part thereof or not, or may cancel any certificate or cancel or vary any direction, and may deal with the application as if it had been made to him in the first instance.
36. (5) Before determining an appeal against this section, the Secretary of State shall, if either the appellant or the authority so desire, afford to each of them an opportunity of appearing before, and being heard by, a person appointed by the Secretary of State for the purpose.
36. (7) The decision of the Secretary of State on any appeal under this section shall be final.

Appeal in  
default of  
decision

37. Where an application for consent under the Order is made to the authority, then unless within two months from the date of receipt of the application, or within such extended period as may at any time be agreed upon in writing between the applicant and the authority, the authority either
- (a) give notice to the applicant of their decision on the application; or
  - (b) give notice to him that the application has been referred to the Secretary of State in accordance with directions given under section 35 above;

the provisions of the last preceding section shall apply in relation to the application as if the consent to which it relates had been refused by the authority, and as if notification of their decision had been received by the applicant at the end of the said period of two months, or at the end of the said extended period, as the case may be.

Power to  
revoke or  
modify the  
consent  
under the  
Order

45. (1) If it appears to the authority that it is expedient to revoke or modify any consent under the Order granted on an application made under Article 3 of the Order, the authority may by Order revoke or modify the consent to such extent as they consider expedient.
45. (2) (Subject to the provisions of sections 46 and 61 of the Act) an Order under this section shall not take effect unless it is confirmed by the Secretary of State; and the Secretary of State may confirm any such Order submitted to him either without modification or subject to such modifications as he considers expedient.
45. (3) Where an authority submit an Order to the Secretary of State for his confirmation under this section, the authority shall furnish the Secretary of State with a statement of their reason for making the Order and shall serve notice together with a copy of the aforesaid statement on the owner and on the occupier of the land affected, and on any other person who in their opinion will be affected by the Order, and if within the period of twenty-

eight days from the service thereof any person on whom the notice is served so requires, the Secretary of State, before confirming the Order, shall afford to that person, and to the authority, an opportunity of appearing before, and being heard by, a person appointed by the Secretary of State for that purpose.

45. (4) The power conferred by this section to revoke or modify a consent may be exercised at any time before the operations for which consent has been given have been completed:

Provided that the revocation or modification of consent shall not affect so much of those operations as has been previously carried out.

45. (5) Where a notice has been served in accordance with the provisions of sub-section (3) of this section, no operations or further operations as the case may be, in pursuance of the consent granted, shall be carried out pending the decision of the Secretary of State under sub-section (2) of this section.

Unopposed  
revocation  
or modification  
of consent

46. (1) The following provisions shall have effect where the local planning authority have made an Order (hereinafter called "such Order") under section 45 above revoking or modifying any consent granted on an application made under a tree preservation order but have not submitted such Order to the Secretary of State for confirmation by him and the owner and the occupier of the land and all persons who in the authority's opinion will be affected by such Order have notified the authority in writing that they do not object to such Order.

46. (2) The authority shall advertise the fact that such Order has been made and the advertisement shall specify (a) the period (not less than twenty-eight days from the date on which the advertisement first appears) within which persons affected by such Order may give notice to the Secretary of State that they wish for an opportunity of appearing before, and being heard by, a person appointed by the Secretary of State for the purpose and (b) the period (not less than 14 days from the expiration of the period referred to in paragraph (a) above) at the expiration of which, if no such notice is given to the Secretary of State such Order may take effect by virtue of this Section and without being confirmed by the Secretary of State.

46. (3) The authority shall also serve notices to the same effect on the persons mentioned in sub-section (1) above.

46. (4) The authority shall send a copy of any advertisement published under sub-section (2) above to the Secretary of State, not more than three days after the publication.

46. (5) If within the period referred to in sub-section (2) (a) above no person claiming to be affected by such Order has given notice to the Secretary of State as aforesaid and the Secretary of State has not directed that such Order be submitted to him for confirmation, such Order shall at the expiration of the period referred to in sub-section (2) (b) of this section take effect by virtue of this section and without being confirmed by the Secretary of State as required by section 45 (2) of the Act.

46. (6) This section does not apply to such Order revoking or modifying a consent granted or deemed to have been granted by the Secretary of State under Parts III, IV or V of the Act.

DATED THIS Tenth DAY OF January 1983

THE COMMON SEAL OF  
THE BOROUGH COUNCIL OF  
KING'S LYNN AND WEST NORFOLK  
WAS HERETO AFFIXED IN THE  
PRESENCE OF:-

*Harold H. Goose*

MAYOR

*J. [unclear]*

BOROUGH SECRETARY



The Borough Council of King's Lynn and West Norfolk, in exercise of the power conferred upon them in that behalf by Section 60 of the Town and Country Planning Act 1971 as amended by the Local Government, Planning and Land Act 1980 hereby confirms the foregoing Order as an unopposed Order.

The Common Seal of The Borough Council of King's Lynn and West Norfolk was hereunto affixed in the presence of:-

Mayor

*Harold H. Goose*

Borough Secretary

*[Signature]*

Dated this Third day of March 1983

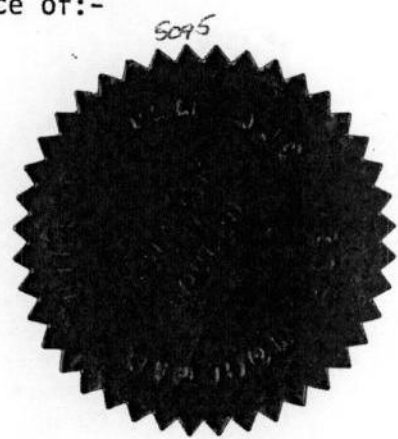



**BOROUGH COUNCIL OF KING'S LYNN  
AND WEST NORFOLK  
TREE PRESERVATION ORDER  
1983 No 1 GRIMSTON & CONGHAM**

AREA LOCATION ONLY

FOR SPECIFIC TREE LOCATIONS SEE ATTACHED SHEETS



**NOTATION**

INDIVIDUAL TREES T1 ETC

AREAS A1 ETC

INNER EDGE OF DOTS DENOTES BOUNDARY

GROUPS G1 ETC

INNER EDGE OF BROKEN LINE DENOTES BOUNDARY

WOODLANDS W1 ETC

INNER EDGE OF LINE DENOTES BOUNDARY

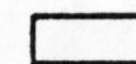
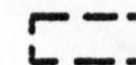
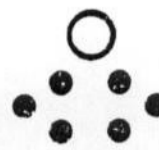

**SCALE  
1:2500**



T1  
 T2  
 T3  
 T4  
 T5  
 T6  
 T7  
 T8  
 T9  
 T10  
 T11  
 T12  
 T13  
 T14  
 T15  
 T17  
 T18  
 T19  
 T20  
 T21  
 T22  
 T23  
 T24  
 T25  
 T26  
 T27  
 T28  
 T29  
 T30  
 T31  
 T32  
 T33  
 T34

T96 T97

Ivy Farm

Grimston

2881  
421ha  
1.04

1978  
603ha  
1.49

8875  
125ha  
31

9166  
069ha  
17

0070  
948ha  
2.34

0062  
3.007ha  
7.43

0062  
170ha  
42  
20.7m

0745  
4.769ha  
11.78

1132  
668ha  
1.65

233  
2.528  
6.25

B.M. 21.72m

B.M. 20.66m

B.M. 21.20m

B.M. 21.19m

19.9m

20.5m

20.6m

21m

Filey

Arn

Thornfields

Lindisfarne

South View

Savilla

Kalpel

Carthia

The Chestnuts

Henros

Prunus

Dawn

Cherry Cottages

Blanes

Home Field House

Haywards

Hewzat

Brensham

Graymède

Sundown

Stony Brook

Willow End

Joyhame

Garage

0745

4.769ha

11.78

The Rafter's

Osborne House

Belvu

Alverstone

Bertelle

Albion House

Tumps Barn

Springfield

Cartref

Pond

Pond

Drain

Drain

Drain

Drain

Drain

Drain

Drain

Drain

Drain

Drain

Drain

Drain

Drain

Drain

Drain

Drain

Drain

Drain

Drain

Drain

Drain

Drain

Drain

Drain

Drain

Drain

Drain

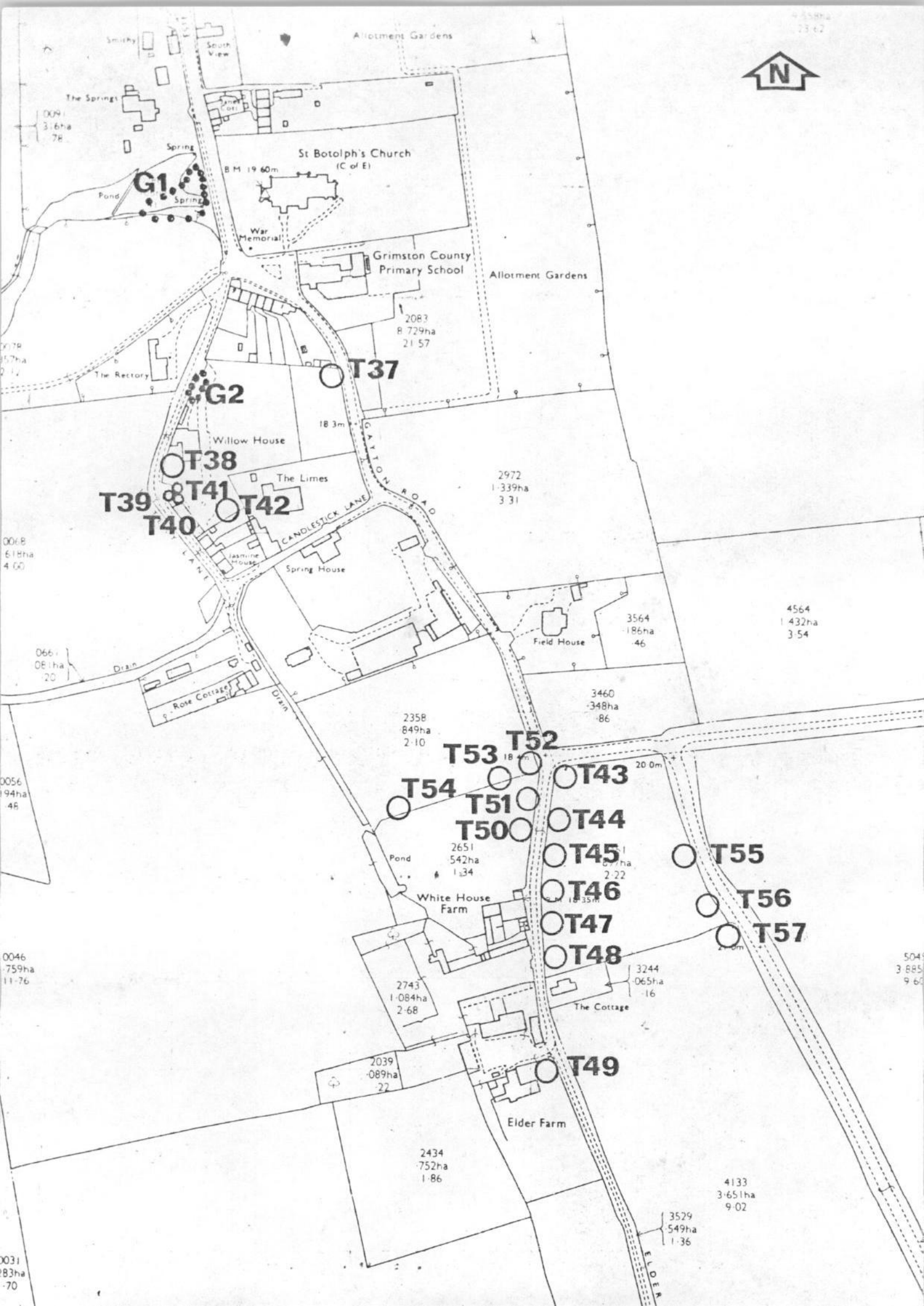

G1

G2

T37

T38

T39

T41

T42

T40

T53

T52

T54

T51

T50

T43

T44

T45

T46

T47

T48

T55

T56

T57

T49

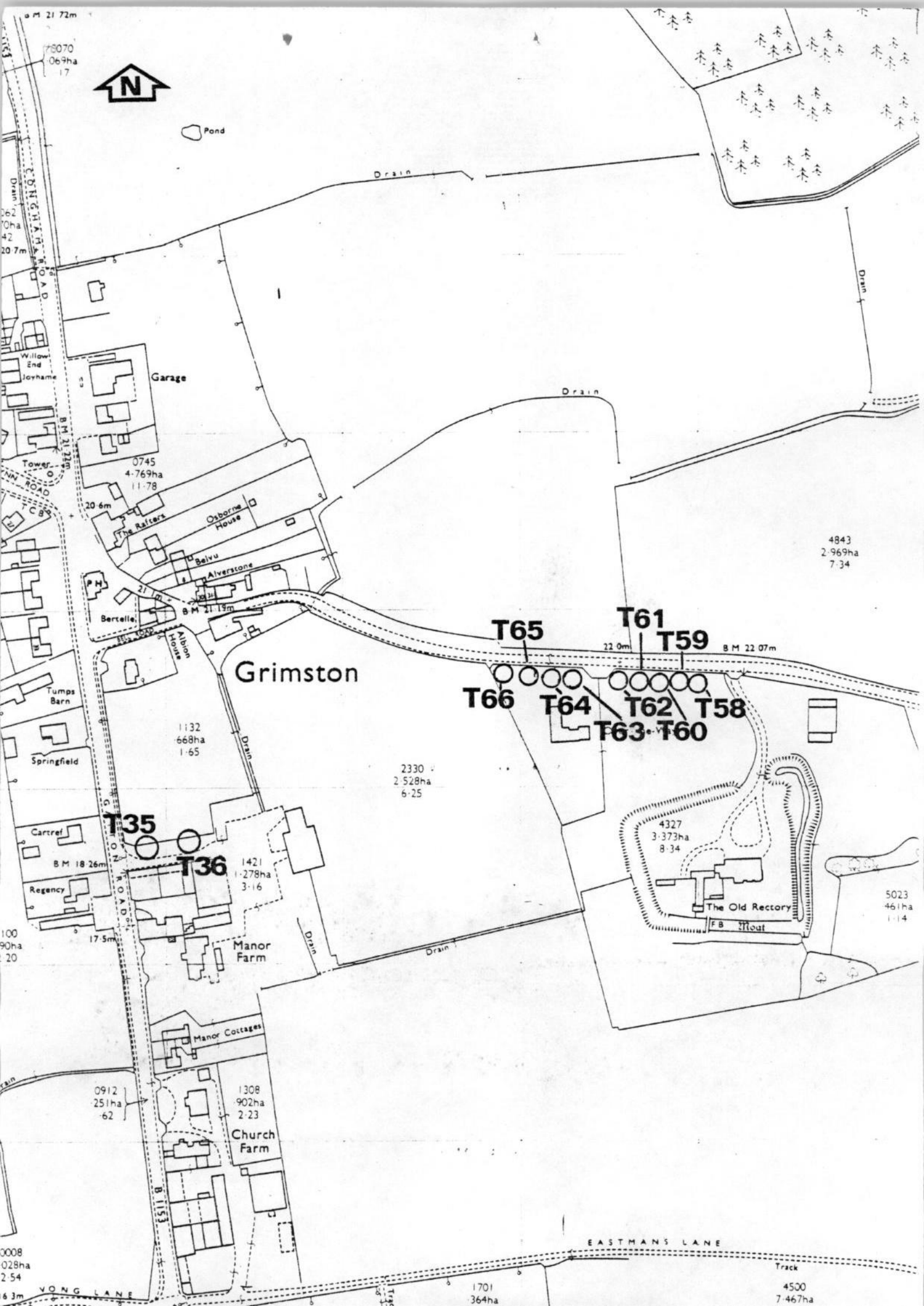

Pond

Drain

Drain

Drain

Drain

EASTMANS LANE

Track

Garage

0745  
4-769ha  
11-78

The Rafter's

Osborne House

Belvu

Alverstone

Bertelle

Albion House

Grimston

1132  
668ha  
1-65

2330  
2-528ha  
6-25

4843  
2-969ha  
7-34

T65

T61

T59

B.M. 22 07m

T66

T64

T62

T58

T63-T60

T35

T36

1421  
1-278ha  
3-16

Manor Farm

Manor Cottages

Church Farm

0912  
251ha  
62

1308  
902ha  
2-23

4327  
3-373ha  
8-34

The Old Rectory

F.B. Mount

5023  
461ha  
1-14

1701  
364ha

4500  
7-467ha

78070  
069ha  
17

062  
70ha  
42  
207m

Willow  
End  
Joyhame

Tower

21-22m

Tumps  
Barn

Springfield

Cartref

B.M. 18 26m

Regency

100  
90ha  
20

0008  
028ha  
2-54

63m

VONG LANE

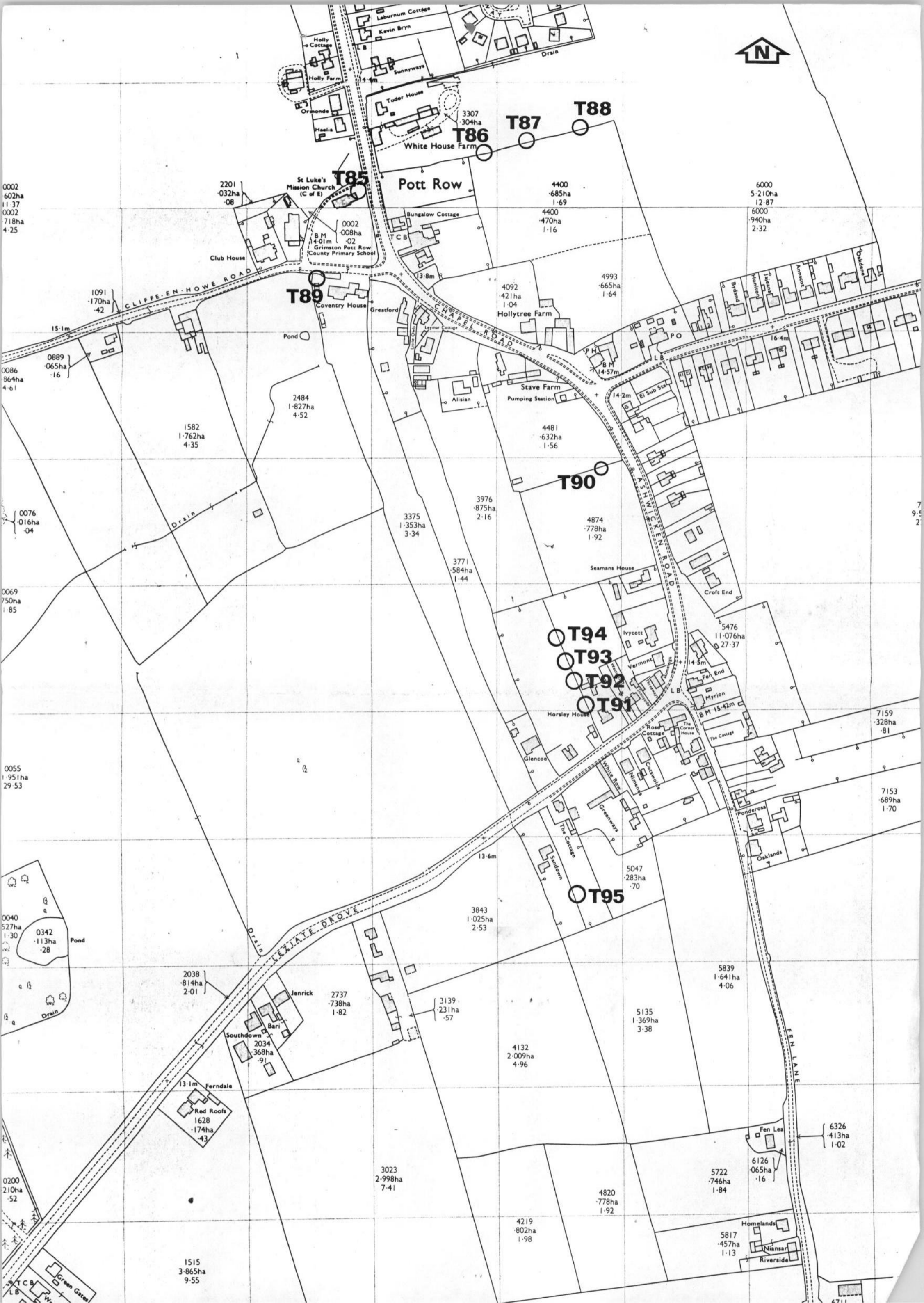

0002  
602ha  
11.37  
0002  
718ha  
4.25

2201  
032ha  
08

3307  
304ha  
T86

T87

T88

4400  
685ha  
1.69

6000  
5.210ha  
12.87  
6000  
940ha  
2.32

1091  
170ha  
42

T89

4092  
421ha  
1.04

4993  
665ha  
1.64

0086  
864ha  
4.61

0889  
065ha  
1.6

2484  
1.827ha  
4.52

1582  
1.762ha  
4.35

T90

3976  
875ha  
2.16

4874  
778ha  
1.92

0076  
016ha  
04

0069  
750ha  
1.85

3375  
1.353ha  
3.34

3771  
584ha  
1.44

T94

T93

T92

T91

5476  
11.076ha  
27.37

7159  
328ha  
0.81

0055  
1.951ha  
29.53

T95

3843  
1.025ha  
2.53

5047  
283ha  
0.70

7153  
689ha  
1.70

0040  
527ha  
1.30

0342  
113ha  
0.28

2038  
814ha  
2.01

2737  
738ha  
1.82

3139  
231ha  
0.57

4132  
2.009ha  
4.96

5135  
1.369ha  
3.38

5839  
1.641ha  
4.06

0200  
210ha  
0.52

131m  
Ferndale

Red Roofs  
1628  
174ha  
0.43

2034  
368ha  
0.91

3023  
2.998ha  
7.41

4219  
802ha  
1.98

4820  
778ha  
1.92

5722  
746ha  
1.84

6126  
065ha  
0.16

6326  
413ha  
1.02

1515  
3.865ha  
9.55

5817  
457ha  
1.13

Homelands  
Niansar  
Riverside

6711

# Roydon

