

KEY

- SHAKESPEARE BARN
- THEATRE SPACES
- PUBLIC SPACES
- STAFF SPACES
- CROFTERS CAFE

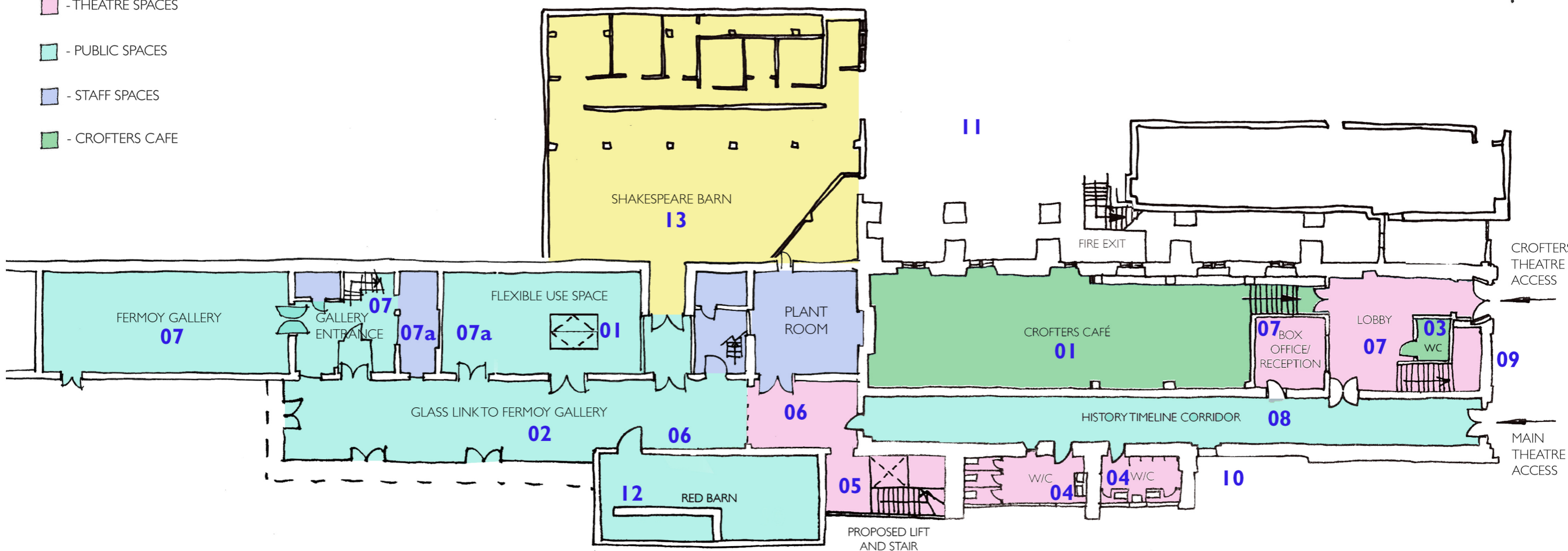

PROPOSED WORKS

- 01.** Existing stair removed and lockable floor hatch added, adapt and retain existing stair, allow for new floor slab, stone tiled floor and mech vent to tunnel
- 02.** New glass extension with zinc roof cladding, timber structure, stone tiled floor
- 03.** Existing services relocated and new accessible WC installed
- 04.** Full refurbishment and new WCs installed
- 05.** New lift and stair extension added, with glass facade and zinc roof, timber structure
- 06.** Existing levels altered, allow for new slab and stone tiled floor finish
- 07.** Light touch refurbishment, redecoration only
- 07a.** Refurbish existing rooms, overhaul joinery, decorate, new floor finishes
- 08.** Full refurbishment, plaster repairs, overhaul joinery, stone floor tiles, decorate
- 09.** Existing notice board removed and new decorative timber door added, with artwork installed
- 10.** Existing fire escape stair removed
- 11.** Clear and clean courtyard
- 12.** Convert exhibition space to new bar, renew floor slab, stone floor tiles and services. Allow for fixtures and fittings
- 13.** Allow for overhauling external and internal fabric, services, sanitaryware etc, allow for decoration

SKETCH DRAWING 900

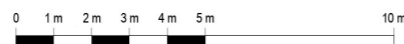

PROPOSED GROUND FLOOR PLAN 1:200 at A3

237497 ST GEORGE'S GUILDHALL

