

Hand-washing technique with soap and water



Wet hands with water



Apply enough soap to cover all hand surfaces



Rub hands palm to palm



Rub back of each hand with palm of other hand with fingers interlaced



Rub palm to palm with fingers interlaced



Rub with back of fingers to opposing palms with fingers interlocked



Rub each thumb clasped in opposite hand using a rotational movement



Rub tips of fingers in opposite palm in a circular motion



Rub each wrist with opposite hand



Rinse hands with water

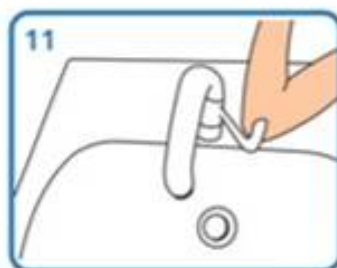

Use elbow to turn off tap



Dry thoroughly with a single-use towel



Hand washing should take 15-30 seconds